

Installation Guide

VMA DN 15

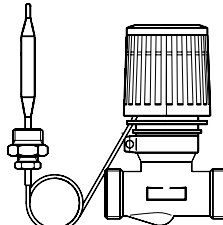

VMA



VMA / RAVI / RAVK / RAVV

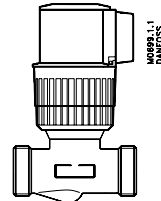

VMA/ABV

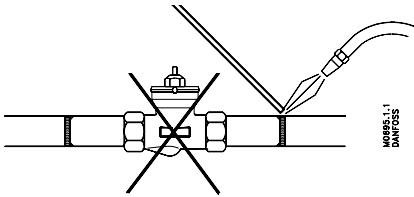

MO898.1.1
DANFOSS

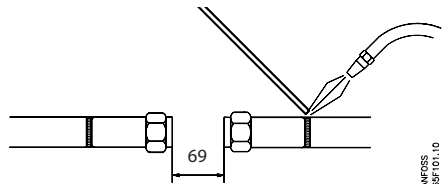

DANFOSS
AESF10.1.10

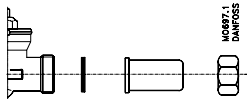

MO897.1
DANFOSS

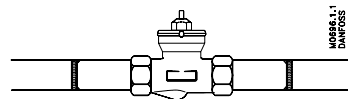

MO898.1.1
DANFOSS

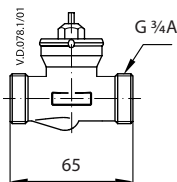

V.D.078.1/01

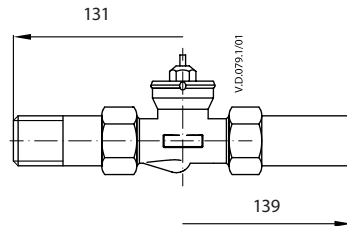

V.D.079.1/01

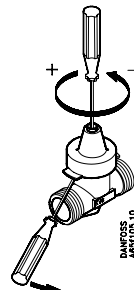
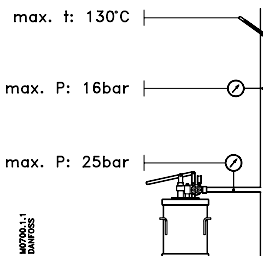

Installation Guide VMA DN 15
